

DuraPoint® Data Sheet

DuraPoint® OEM Module

Features and Benefits

- Completely sealed
- Totally submersible
- No moving parts
- Easy to use
- Safe & reliable
- Meets toughest NEMA standards

Description

DuraPoint® - The World's Toughest "Mouse"

Spill on it, smash it, soak it, drop it, drive on it, whatever! Durapoint, constructed of stainless steel and heavy rubber, is the world's only fully sealed and submersible mouse. DuraPoint is impervious to liquids and contaminants, earning it the toughest industrial equipment ratings - NEMA 4X, 6P, and 13.

Potted solid, DuraPoint is resistant to vibration, shock, ESD, and EMI. And unlike conventional mice and trackballs, DuraPoint has no moving parts to break, wear out, or be cleaned - it's maintenance free! Best of all, DuraPoint is easy and intuitive to use. A simple touch on the mouse button give simultaneous control of both cursor direction and speed.

DuraPoint is the ideal computer pointing solution for factories, warehouses, service bays, operating rooms, field use, and yes, even dirty desktops.

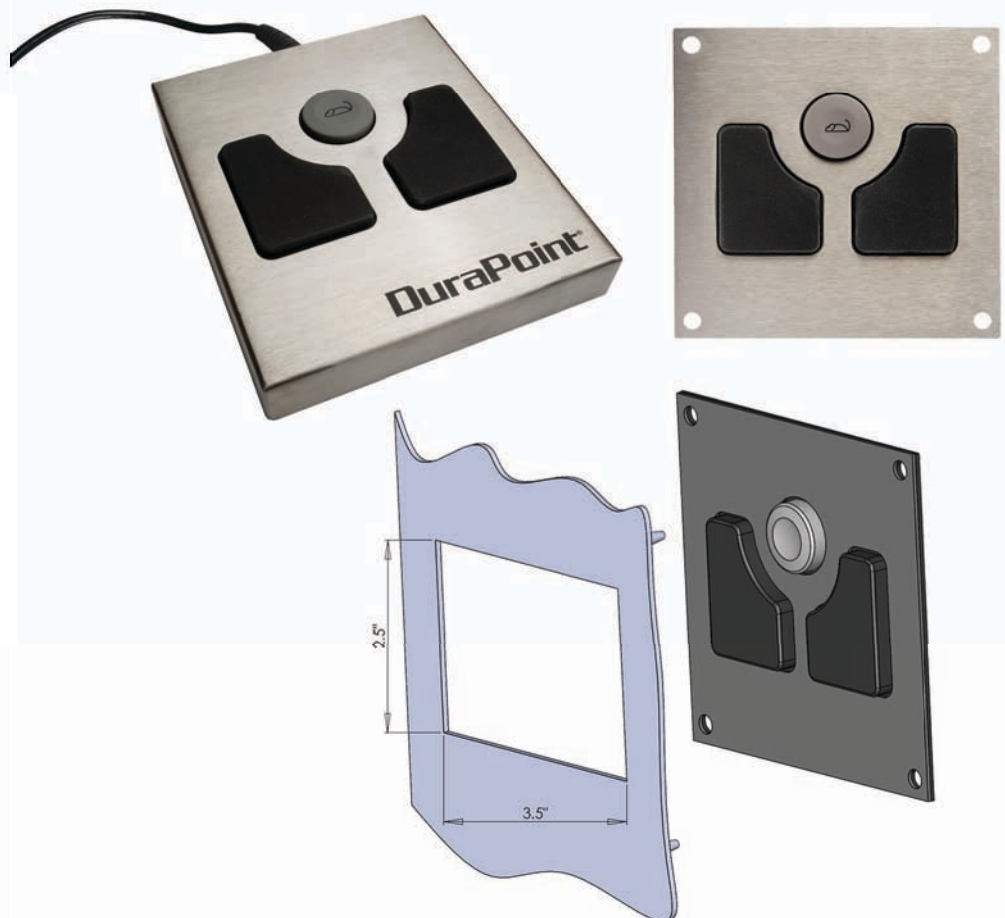

P/N: 94-00054 Rev. A

Embrace the Power of Sensor Technologies

DuraPoint® Specifications

DuraPoint® OEM Module

Compatibilities	Hardware Interface	RS-232 serial port, PS/2® mouse port
	Operating System Compatibilities	PS/2 compatible operating systems
	Serial Data Format	Emulates Microsoft two-button mouse.
	Power Consumption	Less than 10mA @ 5V DC
Physical	Physical Size	5.0" x 4.25" x1.0" (12.8 x 10.8 x2.5cm)
	Weight	2.0lb (900 grams) including cable
	Primary Materials	Stainless steel, silicone rubber buttons, and silicone potting material
	Cables	STANDARD - 6 ft. (1.8m) shielded cable with 9-pin D-sub serial connector (PS/2 adapter included) ENCLOSURE MOUNT - Per standard cable, but includes in-line, low-profile disconnect for use with enclosure cord grips
	Mouting Options	Can be mounted horizontally (desktop) or vertically (panel mount). Four 10-32 inserts are provided on underside for mounting security
Performance	Cursor Directional Control	Continuous 360° control
	Cursor Speed Control	Continuously variable - proportional to applied pressure
	Lifetime	Greater than 10 million cycles
Environmental	Temperature	OPERATING: 32°F (0°C) to 140°F (60°C) STORAGE: -40°F (-40°C) to 185°F (85°C)
	Liquires/Humidity Resistance	Meets NEMA 4X, 6P and 13 standards - completely sealed and submersible
	Particulate/Dust Resistance	Meets NEMA 12 standard - completely sealed against dust and particulates
	Chemical Resistance	Bleach, soap, alcohol, saline, Cidex 7...
	Vibration	OPERATING: 0.5G peak acceleration, 5-500 Hz STORAGE: 5.0G peak acceleration, 5-500Hz
	ESD	IEC 801-2, Level 3
	1 year limited warranty	

Contact Us

**United States
Corporate Office**
Interlink Electronics, Inc.
546 Flynn Road
Camarillo, CA 93012, USA
Phone: +1-805-484-8855
Fax: +1-805-484-9457
www.interlinkelectronics.com
Sales and Support:
sales@interlinkelectronics.com

Japan
Japan Sales Office
Phone: +81-45-263-6500
Fax: +81-45-263-6501
www.interlinkelec.co.jp